

LANDSCAPE ARCHITECTURE & HORTICULTURE

108 LANDSCAPE ARCHITECTURE

110 HORTICULTURE & GARDENING

For more information call (310) 825-9414.

WHAT OUR STUDENTS SAY

“This horticulture program has granted me the opportunity to acquire the skills and knowledge necessary to further my education and follow my passion of growing food. Because of this program I have my dream job!”

– Wendi Dunn, Horticulture Certificate Student

Landscape Architecture

For more information call (310) 825-9414 or email landscapearchitecture@uclaextension.edu.

Note: The Landscape Architecture Program does not support AutoCAD on the Mac.

All CAD courses are fast-paced and complex; absence from any meeting is discouraged. The courses require at least three hours of computer work outside of class per week. Lab hours are not available; therefore, students must have access to their own hardware and software for the courses in which they enroll. Laptops are required for certain courses; check individual course descriptions for specifics.

FREE SOFTWARE AND SOFTWARE LICENSES

Certificate students may download AutoCAD for free upon proof of student status and may be eligible for academic rates on other software for their home computer. Prices and restrictions are subject to change. Software versions should reflect the version used in class as an older version may not possess the same interface or tools demonstrated in class. Each student must verify that his/her computer meets the software's minimum system requirements. For more information call (310) 825-9414.

ARCH X 472 Introduction to the Landscape Design Professions

4.0 units

This introductory course covers the history, scope, types, and scale of landscape design professions; licensure; professional societies; and current issues. Terminology, construction concepts, basic graphic skills, and model-making are also introduced.

Reg# 374438

Fee: \$925

No refund after 30 June.

❖ Remote Instruction

12 mtgs

Wednesday, 7-10pm, June 24-Sept. 2

Saturday, 9am-12pm, July 18

Visitors not permitted. 🌐 📖

Steve Lang, managing principal of the Southern California office of Moore Iacofano Goltman (MIG) in Fullerton. Specializing in park and recreation planning and design, Mr. Lang has been actively involved in award-winning projects for more than 35 years.

ARCH X 472.4D

Design Graphics 1: Drafting and Drawing of the Built Environment

4.0 units

Students learn introductory drafting, lettering, and drawing techniques as they relate to the field of Landscape Architecture and professional standards. All work product is developed from Tongva Park, a real site located in Santa Monica. At the end of this course, students make a presentation to the instructor and visiting guests. The students present a package of work product that includes hand drafting of a dimensioned site plan, section/elevations, and perspective vignettes.

Reg# 374442

Fee: \$925

No refund after 28 June.

❖ Remote Instruction

11 mtgs

Monday, 6:30-9:30pm, June 22-Aug. 10

Sunday, 9am-4pm, Aug. 9

Sunday, 10am-4pm, Aug. 16

Saturday, 9am-5pm, Sept. 5 🌐 📖

David Squires, MA in architecture and urban design, UCLA; BS in landscape architecture and regional planning, Washington State University. Mr. Squires is the principal of AroundYOU, a multi-disciplinary studio offering master planning, solar planning, architectural design, landscape architecture, and garden design.

Laura Razo, BSLA, MLA, project manager/landscape designer, who has more than 13 years of professional experience as a landscape designer and project manager. She received her BS in landscape architecture (BSLA) from Cal Poly, Pomona and received her MLA in 2015.

ARCH X 471.2

Landscape Design 3: Advanced Site Design

5.0 units

This course introduces the student to the landscape architectural design process, emphasizing site inventory, analysis, program, design process, and concept development. Projects are mid- to large-scale sites you can actually visit, such as civic plazas, freeway capping projects, downtown urban redevelopment, etc. The design program for each project is defined by the instructor. Presentation graphics are both hand-drawn and/or physically built. Students also use computer modeling, rendering, 3D modeling, InDesign, Sketchup, and Photoshop. Final presentation products utilize hand graphics with blended use of CAD and 3D modeling as background support only.

Prerequisite(s): ARCH X 471.1A Landscape Design 1; ARCH X 471.1B Landscape Design 2; ARCH X 472.4F Design Graphics 3.

Reg# 374437

Fee: \$1,155

No refund after 1 July.

❖ Remote Instruction

11 mtgs

Thursday, 6-10pm, June 25-Aug. 27

Saturday, 9am-1pm, June 27 🌐

Francisco Behr, BArch, AIA, architect (CA 14634); as president and director of design at Behr Browers Architects Inc. Mr. Behr has more than 25 years of design and planning experience. Mr. Behr has been an instructor for UCLA Extension's Landscape Architecture Program for the past 22 years.

ARCH X 493.992

AutoCAD 1

4.0 units

3.3 CEUs

This course introduces students to the fundamentals of AutoCAD, as well as how to apply and manage the tool. Students who successfully complete the course acquire a good foundation upon which they may further develop the tool. While instruction is directed toward landscape architecture, those in related disciplines also should find the course valuable.

Prerequisite(s): Basic knowledge of computers.

Enroll at uclaextension.edu or call (800) 825-9971

Reg# 374444

Fee: \$1,050

No refund after 30 June.

❖ Remote Instruction

10 mtgs

Wednesday, 6:30-10pm, June 24-Aug. 26

Landscape Architecture certificate students must take this course for unit credit; other students may choose either unit credit or 3.3 continuing education units.

Students must have access to most recent version of AutoCAD software; student versions of the software may be downloaded for free upon proof of student status. UCLA Extension computer labs are not available after class. This course does not support AutoCAD on Mac computers.

Visitors not permitted. 🌐 📖

Victor Corona, AIA, who is a registered architect in the state of California (C25767). Mr. Corona is principal of VMC-architecture, interactive architecture, and interior design firm in Stevenson Ranch, CA. He is a member of the American Institute of Architects, Los Angeles Chapter.

ARCH X 472.6A

History of the Designed Landscape

4.0 units

The Landscape Architecture Program's history course comprises the study of the evolution of landscape design through Western civilization. Lectures cover the outstanding examples of landscape garden design and their relationships to art and architecture, as well as the philosophical, social, political, and historical forces that influenced the designed environment. Instruction includes extensive visual materials.

Reg# 374443

Fee: \$925

No refund after 29 June.

🌐 Online

June 23-Sept. 1 🌐

JC Miller, who is a partner and principal at Vallier Design Associates in Point Richmond, California. He is a licensed landscape architect with a keen interest in the processes, especially the ethical frameworks, which guide the creation of the built environment. He is the former director for the Landscape Architecture Program at UC Berkeley Extension.

ARCH X 472.19

Landscape Design 6: Concept Development

4.0 units

This course explores the use of drawings as tools for visualization and design development. The focus is on developing an ability to use drawings to model and manipulate visual information throughout the various stages of design evolution. Techniques for examining ideas and concept alternatives through composite, perspective, orthographic, and axonometric drawings are explored. Lectures present examples of built projects and methods of recognized professionals, which illustrate the dramatic influence drawing type may have on the final form or organization of a design. The course requires intensive drawing time; students must have already mastered basic drafting and sketching skills. *Prerequisite(s):* X 472.9 Landscape Design 4: Environmental Analysis and Planning.

Reg# 374441

Fee: \$925

No refund after 29 June.

❖ Remote Instruction

12 mtgs

Tuesday, 7-10pm, June 23-Sept. 1

Saturday, 10am-1pm, June 27

Visitors not permitted. 🌐 📖

Charles Ware, BSLA, Ohio State, 1985; MLAUD, Virginia Tech, 1987; MArch, Sci-Arc, 2008. Chuck recently authored an award-winning textbook titled *Landscape Architecture Documentation Standards: Principles, Guidelines, and Best Practices*.

→ → →

Landscape Architecture Curriculum

Students can begin the program sequence Summer or Fall Quarter; courses must be taken in sequence & during the year indicated below.

Year 1

Summer/Fall	Fall/Winter	Winter/Spring	Spring/Summer
Introduction to the Landscape Design Professions (4 units) Design Graphics 1: Drafting and Drawing of the Built Environment (4 units)	Landscape Design 1: Site Design Basics (4 units) Design Graphics 2: Communication for Site Analysis, Conceptual, and Site Design (4 units)	Landscape Design 2: Site Design (4 units) Design Graphics 3: Digital Rendering and Presentation Drawings (4 units)	Landscape Design 3: Advanced Site Design (5 units) AutoCAD 1 (4 units) History of the Designed Landscape (4 units) <i>Only Offered Summer Quarter</i>

Year 2

Fall	Winter	Spring	Summer
Grading & Drainage (4 units) Plant Materials: Trees (4 units) Portfolio Review	Landscape Design 4: Sustainable Design/ Environmental Analysis and Planning (4 units) Plant Materials: Shrubs (4 units)	Landscape Design 5: Planting Design (4 units) AutoCAD 2 (4 units)	Landscape Design 6: Concept Development (4 units) Irrigation/Water Conservation (4 units)

Year 3

Fall	Winter	Spring	Summer
Landscape Construction Methods & Materials (4 units) Construction Drawing 1 (4 units) Professional Practices in Landscape Architecture (2 units)	Construction Drawing 2 (4 units) Human Factors in Landscape Architecture (4 units)	Landscape Design 7: Advanced Design Studio (5 units) Capstone Project Seminar (3 units)	Capstone Project Studio (10 units) Portfolio Review

- 6 elective units must be inserted into the 3-year plan before beginning the Capstone Project Studio.
- Students beginning Summer Quarter should expect the program to last 3 years and 1 quarter. They will receive individual advising and a slightly altered sequence.

For More Information

(310) 825-9414 | landarch.uclaextension.edu

ARCH X 472.12B

Irrigation/Water Conservation

4.0 units

This course focuses on irrigation system design, specifications, and construction. Instruction emphasizes water conservation and techniques of efficient and appropriate application. Various systems and techniques are explored, as well as concepts for system modernization, reclamation, and water management.

Prerequisite(s): X 472.12A Grading and Drainage, X472.5 Landscape Design 5: Planting Design, and X 493.6 AutoCAD 2.

Reg# 374439

Fee: \$925

No refund after 30 June.

❖ Remote Instruction

11 mtgs

Wednesday, 7-10pm, June 24-Sept. 2

Students should have their own version of AutoCAD.

Laptop highly recommended.

Visitors not permitted. → ↻

Jeff Chamlee, BLA, landscape architect (CA 1736); director of productions for Architect Design Group. With more than 35 years' experience in a diverse array of project types, such as Kenneth Hahn State Recreation Area, Veterans Memorial Regional Park in Sylmar, and Roxbury Memorial Park in Beverly Hills, among many others.

Free Information Session!

Landscape Architecture

Saturday, August 8, 9:30-11:30am

UCLA Extension's Landscape Architecture Certificate is approved to meet the education requirement for licensure in California.

Highlights include:

- Presentation of the curriculum
- Discussion of career opportunities
- Question-and-answer period
- Talk with instructors, alumni, and current students
- A drawing to win a free course
- 10% off selected courses for new students

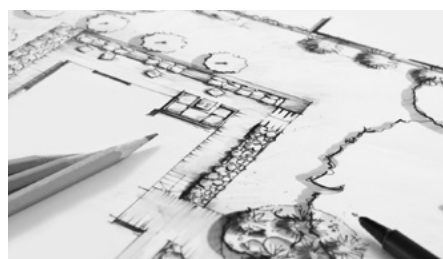

To register, use Reg# 374436 at uclaextension.edu.

For more information call (310) 825-9414.

Landscape Architecture Electives

Some Horticulture & Gardening courses count toward elective requirements in the Landscape Architecture certificate.

Horticulture & Gardening courses begin on page 110.

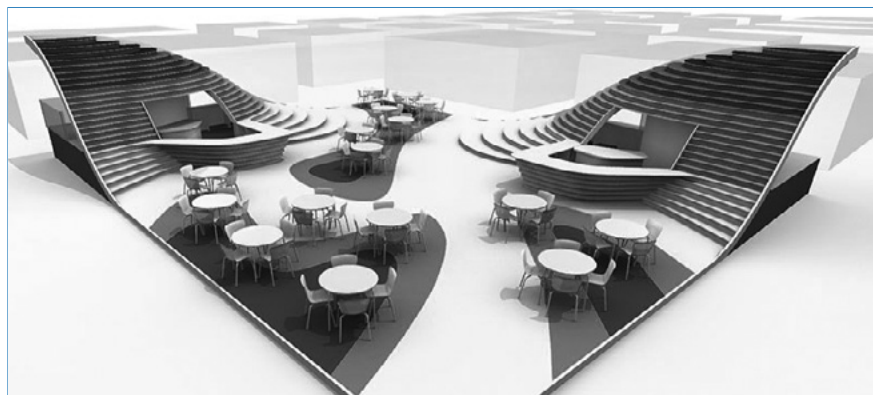

Rhinoceros

Saturdays, 10am–2pm

Laptop Course

This course will teach students fundamental modeling techniques and procedures in the 3D modeling software Rhinoceros 6, as well as their practical application in the field of Landscape Architecture. It will examine the limits of the software through a series of modeling exercises intended to showcase Rhinoceros 6's capabilities in representing landscapes, spaces, and objects at a variety of scales. Basic means and methods to output modeled content for further use and development will be demonstrated.

Page 110.

For More Information

(310) 825-9414 | uclaextension.edu



Become a

Landscape Architect

Summer Quarter is the perfect time to start the Landscape Architecture Certificate with our two introductory courses.

ARCH X 472 Introduction to the Landscape Design Professions

Page 108.

ARCH X 472.4D Design Graphics I: Drafting and Drawing of the Built Environment

Page 108.

- Designed for working professionals and those looking for a career change, this three-year, intensive program prepares you for the exciting and wonderful world of landscape architecture.
- You do not need to be a certificate student to enroll in the introductory courses.

Above: Jessyca Frederick

For More Information or Detailed Course Descriptions

(310) 825-9414 | landarch.uclaextension.edu

ARCH X 472.15D

Capstone Project Studio

10.0 units

The Capstone Project Studio is an intensive course in which students develop a comprehensive and creative final design project that reflects their special interests and demonstrates the theory, skills, and knowledge acquired over the two-and-a-half prior years of study in the Landscape Architecture Program. Students select individual projects and complete the Capstone Studio Project in 12 weeks. Small studio groups meet twice weekly under instructor guidance to review their work in progress. Class sessions include discussion of design theory and process, programming, design concepts, and graphic communication. The student will prepare for weekly critiques and meet milestones. Completed projects are presented before instructors, guidance committee members, and local professionals at approximately week 11.

Prerequisite(s): X 472.15C Capstone Project Seminar.

Reg# 374440

Fee: \$2,310

No refund after 28 June.

- ❖ *Remote Instruction*

24 mtgs

Monday, Thursday, 6-10pm, June 22-Aug. 31

Thursday, 5-10pm, Sept. 3

Saturday, Sunday, 8am-5pm, Sept. 5-6

Restricted course. Students who wish to take this course must request permission from the program office before they can enroll.

Visitors not permitted. 🌐

Meg Rushing Coffee, landscape architect (CA 4747). Ms. Coffee has her own practice specializing in residential design. Previously, she worked with Pamela Burton & Company, OLIN, and Marmol Radziner & Associates. She is vice chair of the UCLA Landscape Architecture Program Instructor Committee and Secretary of the Association for Women Architects and Designers (AWA+D).

Jim Pickel, BS, (CA 4385), ASLA, past principal of MIG, Inc. (retired) who is a licensed landscape architect in California and Texas with 37 years' experience. He currently serves on the executive board of the California Council of the American Society of Landscape Architects.

ARCH X 493.883

Rhinoceros

3.0 units

This course explores new methods to conceive, create, and represent landscape through the 3D modeling software Rhinoceros. Investigations during the course will commence with visions of landscape surfaces and their manipulation. Further exploration will cover objects, buildings, structures, follies, and architecture that inhabit this landscape. Throughout these studies, students will revisit and reconceive the relations between their landscape strategies, the things that inhabit them, and how to represent them.

Reg# 374971

Fee: \$695

No refund after 10 July.

- ❖ *Remote Instruction*

6 mtgs

Saturday, 10am-2pm, July 11-18; Aug. 1-15;

Aug. 29

Class meets every other Saturday.

Laptop course.

Students are required to use their personal laptops each class with Rhino 6 software installed.

Instructor does not help students install or download software.

Knowledge of Adobe Photoshop and Illustrator are required. 🌐

Jeremy Jarin, Jeremy Jarin has been working as a landscape designer at Studio-MLA for the past 5 years. He is involved in a variety of local projects applying his knowledge of graphic representation platforms and 3D modeling to assist in producing presentation materials and construction documents.

Horticulture & Gardening

Enrollment is open to anyone interested in learning the science of horticulture or the common techniques to successful gardening.

For Horticulture Certificate information visit horticulture.uclaextension.edu.

BIOLGY X 499

Plant Materials for Landscape Use

4.0 units

This course presents the characteristics of up to 150 plants selected for their garden use and seasonal interest in the Southern California area. Topics include trees, shrubs, ground covers, vines, and herbaceous plants, emphasizing their landscape use, appropriate placement, horticultural care, and ornamental features. The first class is held on campus, followed by field trips by itinerary. A course project is required for all credit students.

Reg# 374608

Fee: \$625

No refund after 10 July.

- ❖ *Remote Instruction*

9 mtgs

Sunday, 12-5pm, June 28

Sunday, 12:30-3:30pm, July 12-Aug. 23

Sunday, 12-5pm, Sept. 6

Core course in Horticulture Certificate.

Visitors not permitted. 🌐

Joshua Rosen, a licensed landscape architect who is passionate about the use of a diverse, climactically-appropriate plant palette. He has worked in Los Angeles on a wide range of landscape project types for nearly 15 years, serves on the Santa Monica Architectural Review board, and is the founder of Airplantman, a tillandsia display company.

BIOLGY X 497.5

Gardening Practices and Techniques

4.0 units

This course offers a practical introduction to the basics of maintaining a home garden. At their garden plot, students gain first-hand experience in tool selection and care, soil preparation, planting, fertilizing, and watering. Topics include common landscape problems and solutions; our special climate and microclimates, including sun and shade exposures; various pruning techniques; types of irrigation systems; gardening in containers; and gardening with color including perennials, annuals, and bulbs.

Reg# 374607

Fee: \$625

No refund after 28 June.

- ❖ *Remote Instruction*

Date and Time TBA

Core course in the Gardening Specialization. Elective course in the Horticulture Certificate

Visitors not permitted. 🌐

Instructor to be announced